

Long Work Distance Fiber Collimators

- series 1

Long work distance collimator can provide near parallel beam up to 200 meters. Aberration is corrected to emit the near diffraction limit light with separated lenses. But effective focal length is still affected by wavelength. So, this collimator performs best at the specified wavelength.



Schematic Diagram of Long Work Distance Fiber Collimators

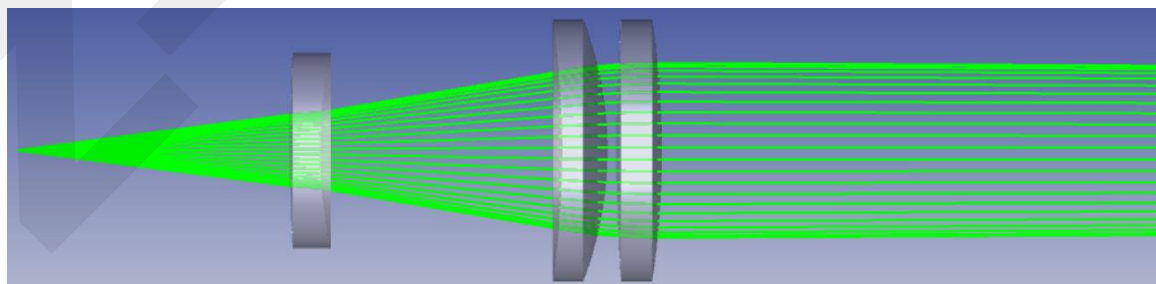
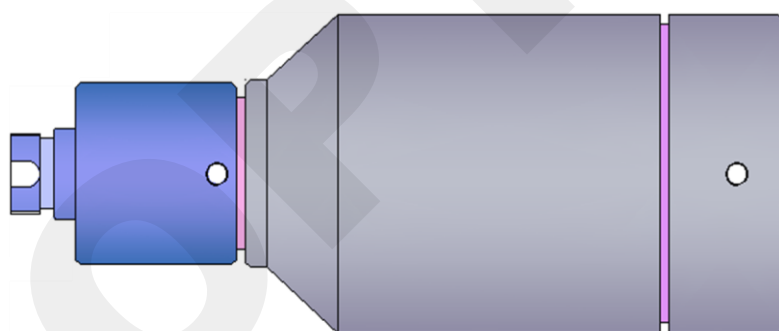

Long Work Distance Fiber Collimators

400~905nm Long Work Distance SM Fiber Collimators

Wavelength (nm)	Bandwidth (nm)	Waist Beam (mm)	Div. (mrad)	EFL (mm)	NA (Lens)	Transmittance	Fiber Type	Connector
405	±30	10.2	0.09	66.5	0.19	>92%	405HP	FC/PC FC/APC Sma905
450	±30	13.7	0.07	68.4	0.18		460HP	
520	±30	14.2	0.06	70.3	0.18		630HP	
635	±30	14.5	0.07	72.1	0.17			
780	±30	14.2	0.07	73.3	0.17		780HP	
850	±30	14.9	0.07	73.7	0.17			
905	±30	14.9	0.07	73.9	0.17			

980~1650nm Long Work Distance SM Fiber Collimators

Wavelength (nm)	Bandwidth (nm)	Waist Beam (mm)	Div. (mrad)	EFL (mm)	NA (Lens)	Transmittance	Fiber Type	Connector
980	±30	15	0.09	74.2	0.17	>92%	980HP	FC/PC FC/APC Sma905
1064	±30	15.2	0.09	74.5	0.17			
1310	±30	12.9	0.12	75.1	0.17		Smf-28e	
1550	±30	14.2	0.14	75.6	0.17			
1650	±30	14.5	0.14	76	0.17			

Long Work Distance Fiber Collimators

400~905nm Long Work Distance Multimode Fiber Collimators

Wavelength (nm)	Bandwidth (nm)	Waist Beam (mm)	Div. (mrad)	EFL (mm)	NA (Lens)	Transmittance	Fiber Type	Connector
450	±30	25	2	50.11	0.25	>92%	62.5/125	FC/PC FC/APC Sma905
	±30	22	4.9	50.11	0.25		200/220	
	±30	22	8.93	50.11	0.25		400/440	
485	±30	22	2.75	50.1	0.25		105/125	
	±30	22	4.6	50.1	0.25		200/220	
525	±30	25	2.4	50.12	0.25		62.5/125	
	±30	22	2.5	50.12	0.25		105/125	
	±30	22	4.5	50.12	0.25		200/220	
	±30	22	8.5	50.12	0.25		400/440	
635	±30	25	2	50.2	0.25		62.5/125	
	±30	22	2.3	50.2	0.25		105/125	
	±30	22	4.6	50.2	0.25		200/220	
	±30	22	8.2	50.2	0.25		400/440	
780	±30	25	4.1	49.17	0.25		62.5/125	
	±30	22	2.5	49.17	0.25		105/125	
	±30	22	4.4	49.17	0.25	200/220		
850	±30	22	4.1	50.05	0.25	62.5/125		
	±30	22	2.4	50.05	0.25	105/125		
	±30	22	4.3	50.05	0.25	200/220		
	±30	22	8.4nrad	50.05	0.25	400/440		
905	±30	10.9	4.5	24.99	0.25	105/125		
	±30	10.9	8.3	24.99	0.25	200/220		

980~1650nm Long Work Distance Multimode Fiber Collimators

Wavelength	Bandwidth	Waist Beam	Div. (mrad)	EFL	NA(Lens)	Transmittance	Fiber Type	Connector
1064nm	±30nm	25.0mm	4.5mrad	49.84mm	0.25	>92%	62.5/125	FC/PC FC/APC Sma905
	±30nm	21.2mm	2.8mrad	49.84mm	0.25		105/125	
	±30nm	21.2mm	4.9mrad	49.84mm	0.25		200/220	
	±30nm	21.2mm	9.3mrad	49.84mm	0.25		400/440	
1310nm	±30nm	25.0mm	4.5mrad	49.97mm	0.25		62.5/125	
	±30nm	21.2mm	2.7mrad	49.97mm	0.25		105/125	
	±30nm	21.2mm	4.8mrad	49.97mm	0.25		200/220	
	±30nm	21.2mm	9.2mrad	49.97mm	0.25		400/440	
1550nm	±30nm	25.0mm	4.5mrad	50.16mm	0.25		62.5/125	
	±30nm	21.2mm	2.7mrad	50.16mm	0.25		105/125	
	±30nm	21.2mm	4.8mrad	50.16mm	0.25		200/220	
	±30nm	21.2mm	9.1mrad	50.16mm	0.25		400/440	