



LD1625-5-1

●Specifications:

Wavelength: 1625nm
 Power: 5mW CW
 Package: TO18

●Absolute Maximum Ratings($T_c=25^\circ\text{C}$):

Parameter		Symbols	Ratings	Units
Light Output	CW	P_o	5	mW
Reverse Voltage	Laser	V_r	2	V
	PD	-	-	V
Operation Temperature		T_{op}	10~+30	$^\circ\text{C}$
Storage Temperature		T_{stg}	-40~+85	$^\circ\text{C}$

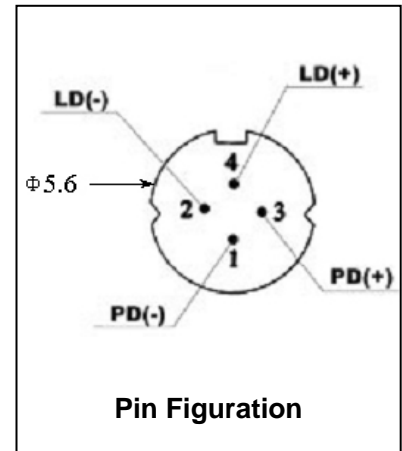

●Electrical and Optical Characteristics($T_c=25^\circ\text{C}$):

Parameter		Symbols	Condition	Min.	Typ.	Max.	Unit
Lasing Wavelength		λ_p	-	1600	1625	1650	nm
Spectral Width		$\Delta\lambda$	-	-	3	-	nm
Emitter Size		-	-	4x1			μm
Wavelength / Temperature		-	-	-	0.3	-	nm/ $^\circ\text{C}$
Threshold Current		I_{th}	-	-	15	-	mA
Operating Current		I_{op}	-	-	50	-	mA
Operating voltage		V_{op}	-	-	2.0	-	V
Beam ¹⁾ Divergence	Parallel	$\theta_{//}$	-	-	20	-	deg.
	Perpendicular	θ_{\perp}	-	-	40	-	deg.
Slope Efficiency		η	-	0.12	-	-	mW/mA

1) Full angle at half Maximum



Tel: (+86) 577-8181-0885
 Fax: (+86)577-6286-6900
 www.z-optics.com
 Sales@z-optics.com

●Dimensions:

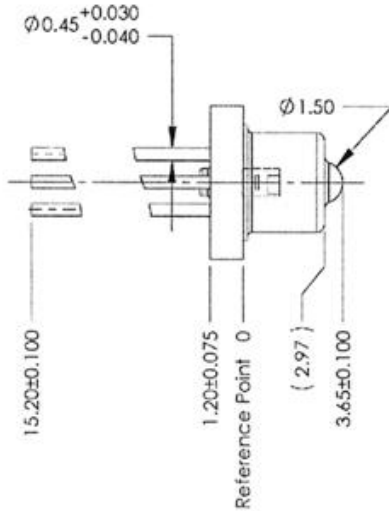

Ball Lens Windows

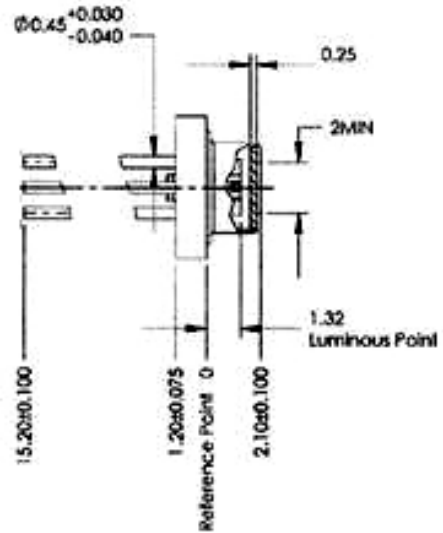

Flat Windows

●Typical Characteristic Curve:

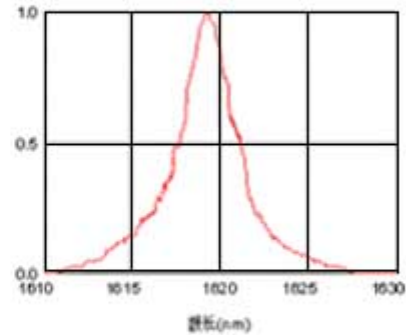
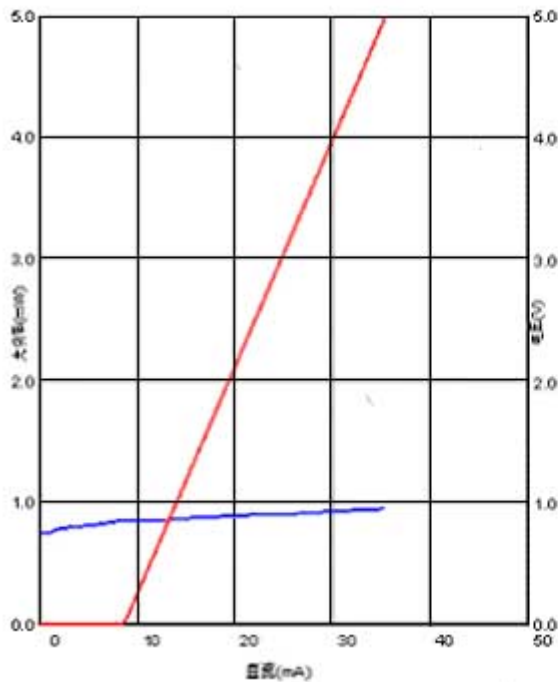

Z-Optics LIMITED
 Hailong Building C301, Xiaonan Road
 Wenzhou, Zhejiang Province
 325028, China